

enviPASS

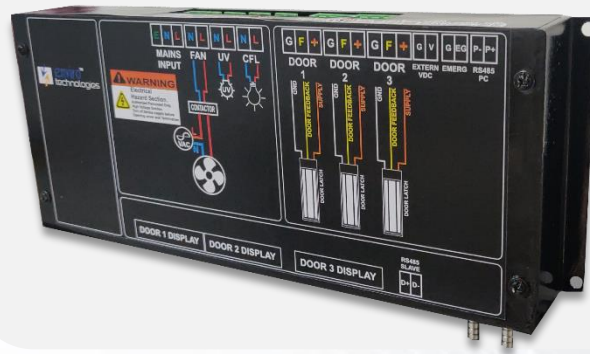

Pass Box is used for material transfer from one clean room to another clean room. It consists of a rectangular **box** with two/three doors. All doors are interlocked such that more than one door cannot be opened at the same time, to prevent pressure losses and cross contamination.

enviPASS achieves this by ensuring that before Door 1 of a Pass Box is opened, Door 2 and Door 3 are closed. There are two/three LCD Display Cum Operator Panels (LCD Display Panels), one each to be mounted above each door. The panel has 16 X 2 backlit LCD to display door status, UV life span, CFL, FAN, UV status, Differential Pressure & filter life. (All display information depend on model selection)

FEATURES

- Advance 32-bit Microcontroller Based System.
- User can configure settings using front membrane keypad.
- LED status indication for door, CFL, UV, blower and emergency.
- In-built UV and Blower interlocking feature along with door interlocking.
- In-built UV hour meter with UV life expire alert along with reset count functionality.
- Inbuilt Module for Differential pressure monitoring.
- External MODBUS based differential pressure display interface provision.
- Buzzer alarm for High DP & Low DP in case of dynamic pass box controller.
- Emergency Key on display interface.
- Standard MODBUS RTU protocol for further integration.

ACCESSORIES

ELECTROMAGNETIC DOOR LOCKS

- Holding force: Holding force 300LBS/136Kg
- Dimensions: 146 (L)x 49 (W)x 25 (H) mm
- Armature plate: 126 (L)x 40(W)x 7(H) mm
- Rating: 12VDC/300 to 350 mA
- Feedback Sense: Reed Switch Type
- Operating temp: 10 ~ 55 °C



LCD DISPLAY PANEL

- LCD: 16 x 2 Backlit LCD
- Door Open LED indication: Available
- Enclosure MOC: SS304
- Mounting: Flush panel



APPLICATIONS

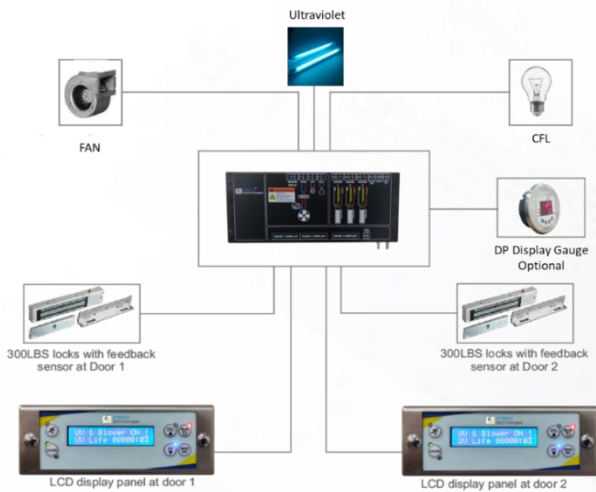

←Fig.1. For 2 Door Systems

Fig.2. For 3 Door Systems→

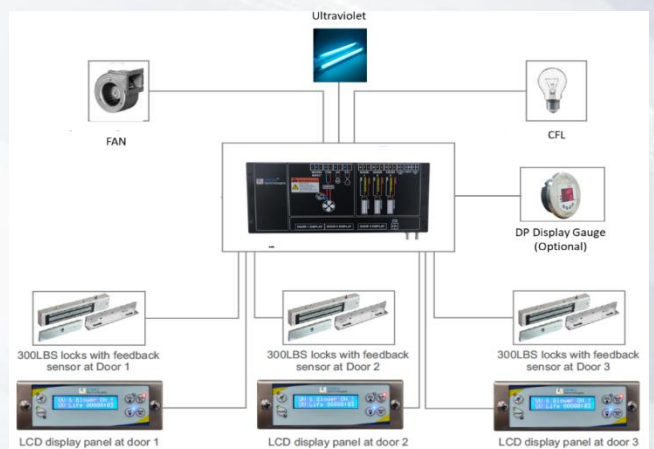

SPECIFICATIONS

Particulars	Description
ModelNo.	EPS-SA2-KXX-OXA(StaticPassbox) 2 Doors. EPS-DA2-K40-OXA(DynamicPassbox) 2 Doors. EPS-SA3-KXX-OXA(StaticPassbox) 3 Doors. EPS-DA3-K40-OXA(DynamicPassbox) 3 Doors.
Type	Advanced32bitMicrocontrollerbasedsystem. 1. StaticPass Box. 2. DynamicPass Box.
Max DoorCount	2 Doors/3 doors.
IndicationType	Audio:Buzzer. Visual:16X2Bluealphanumeric displayandstatusLEDs.
ElectricalInput	1. Universal Main Input voltage 110-230VAC/50Hz Single Phase Power Supply 2. Magnetic Door Sense Input for each door.
ElectricalOutput	
1. Relay Rating.	Potentialfree relayforswitchingofUV,CFLandBlower. 5A@230VACPotentialfreeChangeOverContacts.
2. Electricallife	1,00,000Operations.
3. EMLOutput	500mA/12VDC for driving single magneticlock.
Communication:	Standard MODBUSRTU protocol (optional)
PhysicalDimension(mm):	
1.Controller	Size:204(L)x37(H)x108(W)mmControlCard.
2.DisplayModule	Size:152(L)x51(H)x20(W)mm.Display Card.
2. Material: a. Main Board b. Display module	MS,Powdercoated. FrontSS-304plate.
4.Mounting	FlushMountforDisplay&WallMount for Controller.
5. Operating Temperature & Humidity.	Temperature 10 to 50 Deg C. Humidity 45% to 60% Rh.

TECHNICAL SPECIFICATION

CONNECTION DIAGRAM

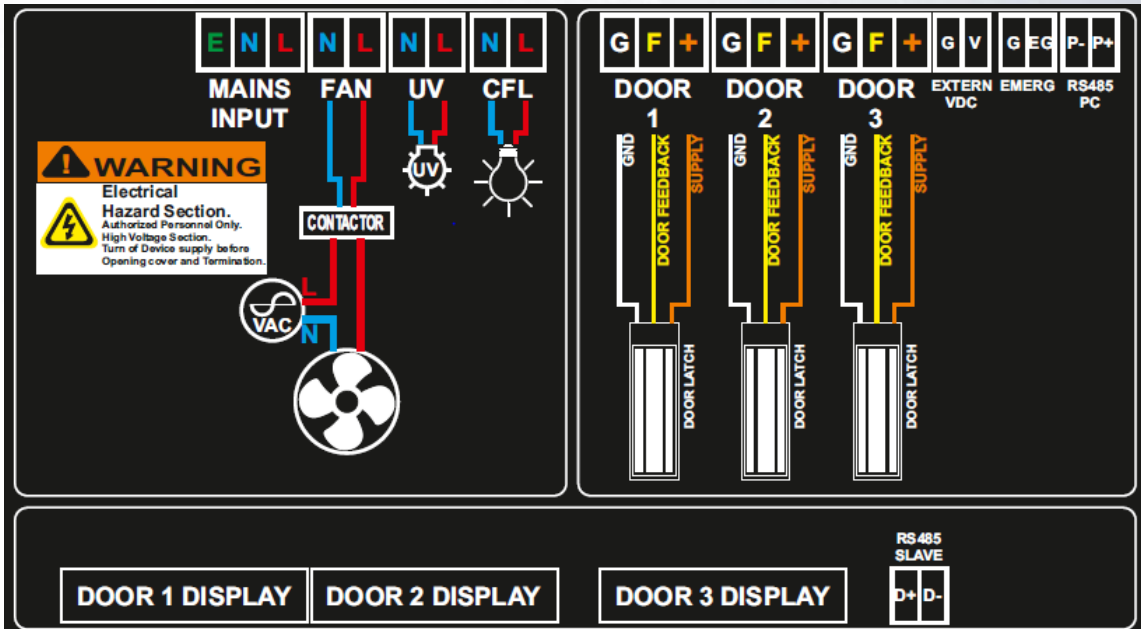

DIMENSIONS

Main Controller Box Dimensions: (For 2 & 3 Doors)

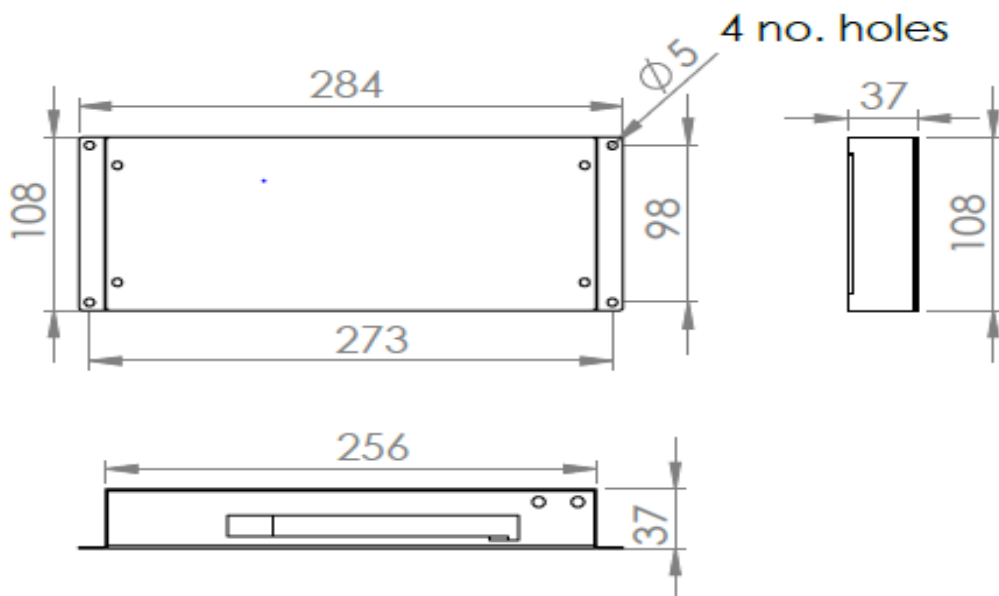

Note: All specifications are subject to change without notice due to continuous improvements.



We proudly champion



TECHNICAL SPECIFICATION

Display Board Dimensions:

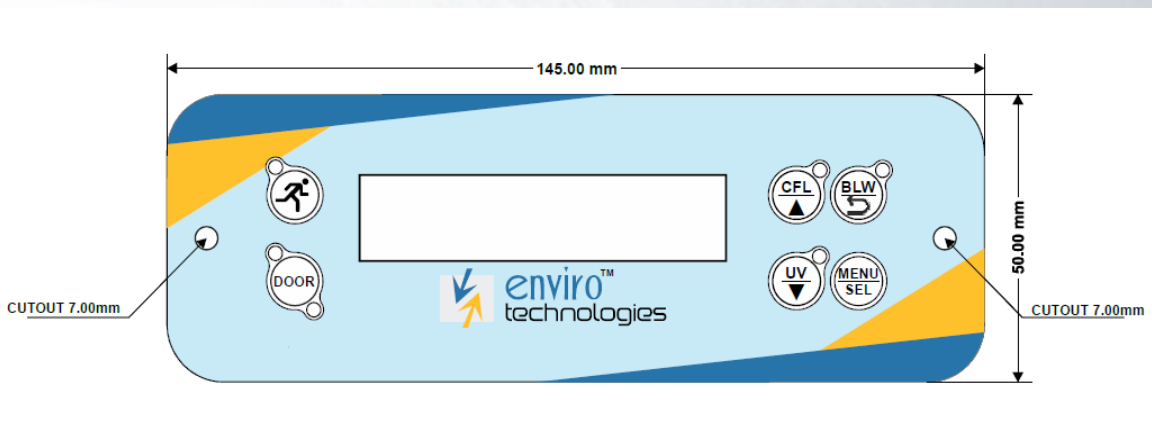

Display Back Side Dimensions:

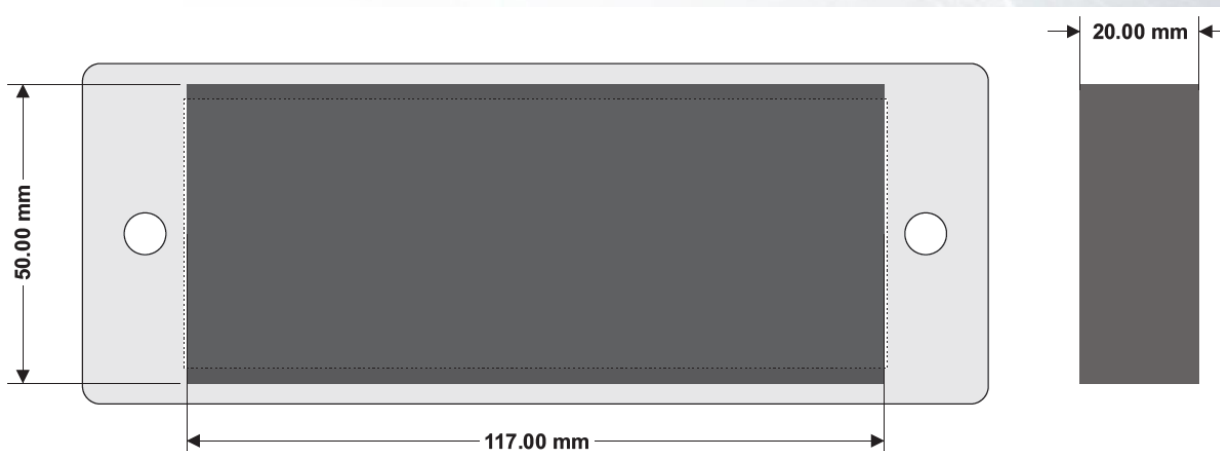

Display Cut-out Dimensions:

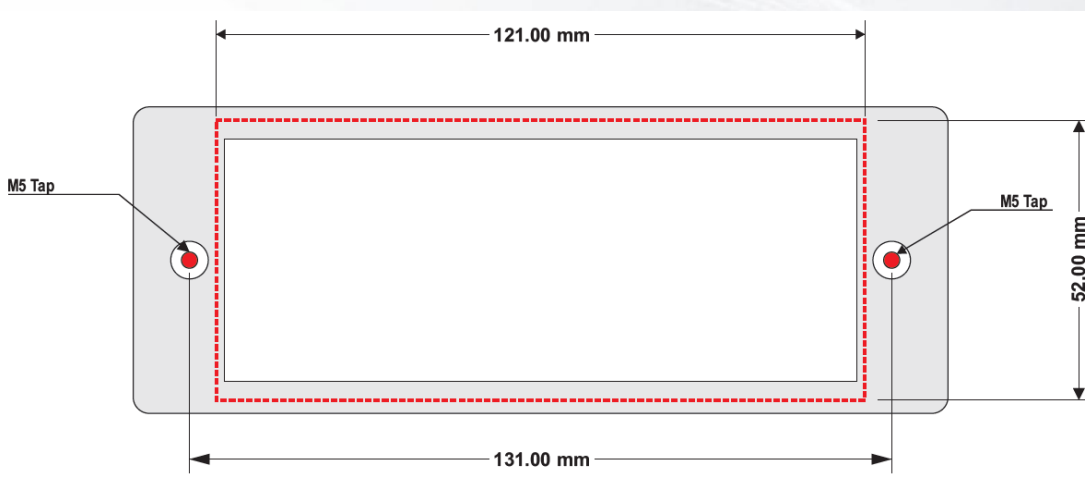

Note: All specifications are subject to change without notice due to continuous improvements.



TECHNICAL SPECIFICATION

Display Front Bezel Plate Dimensions:

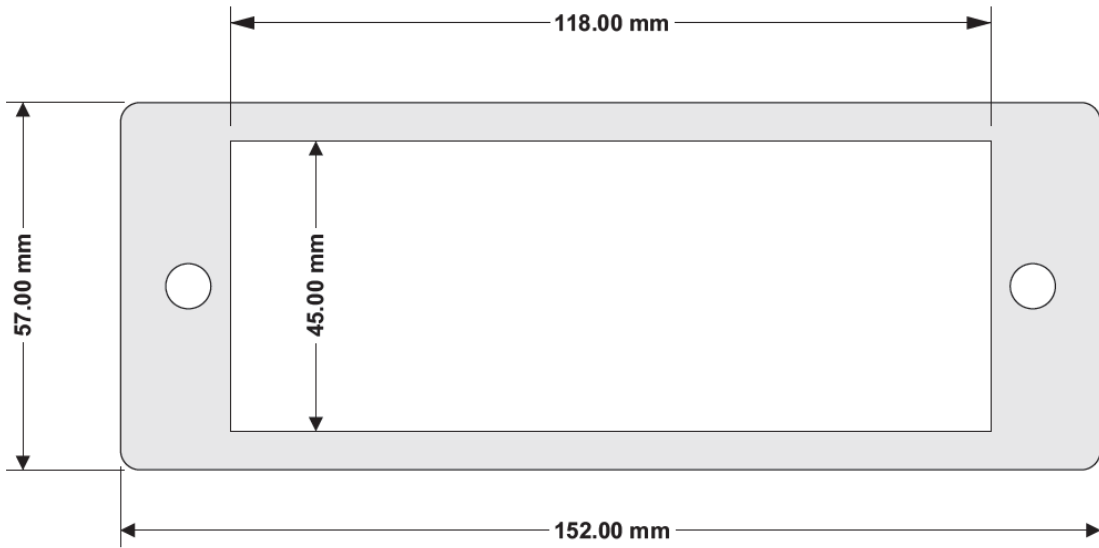

Display Back Enclosure:

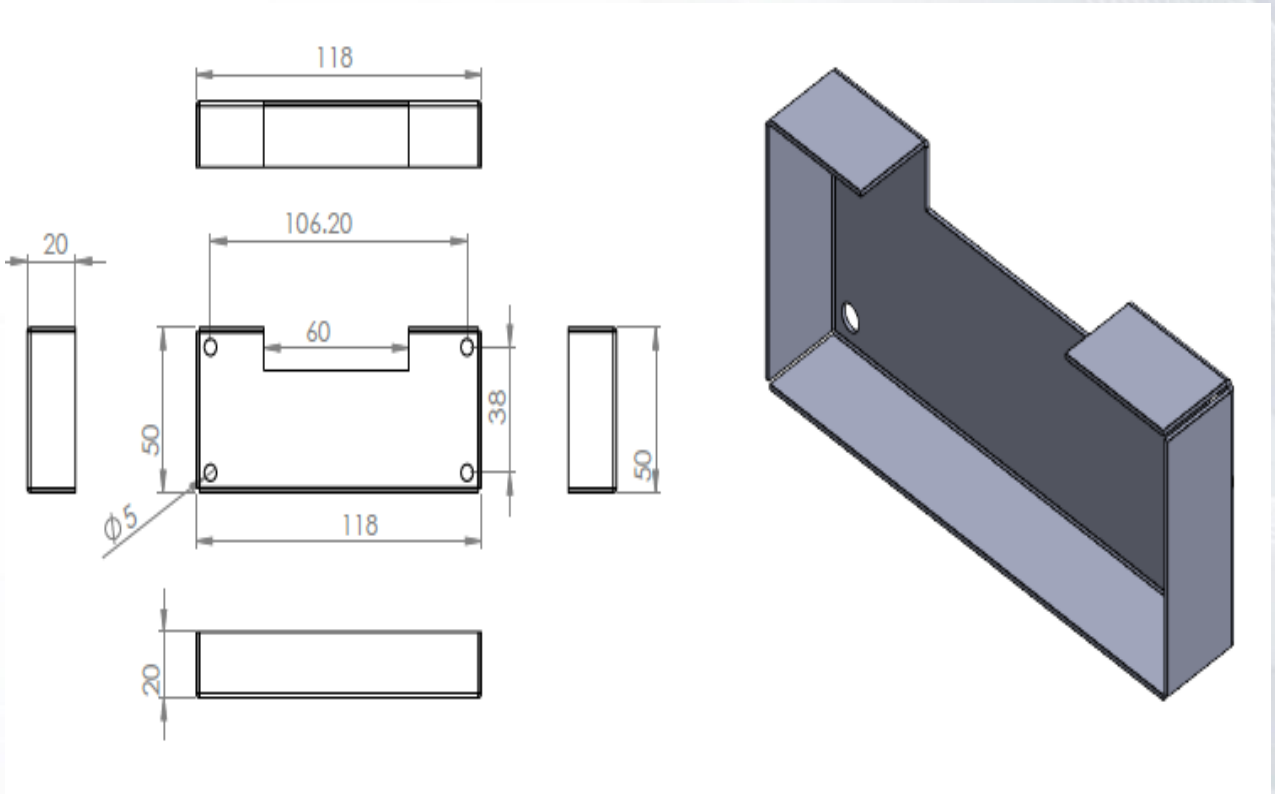

Note: All specifications are subject to change without notice due to continuous improvements.

ORDERING DETAILS

EPX-XAX-KXX-XXA

Tactile Keypad

X=No Communication
R=RS485 communication
0= No External Sensor
1=RS485 Based External Sensor

XX=No DP Sensor
40=In Built DP Sensor

CHANNEL
TYPE

2=2 Doors
3=3 Doors

Alpha Numeric
Display

S=STATIC
D=DYNAMIC

S=STANDARD
F-=FLAMEPROOF

Enviro Technologies Pass Box



Enviro technologies

1st Floor, Arihant Plaza, Phase – 2, Ovala Village, Ghodbunder Road,
Thane (West) 400 607. Board line: +91-9594-030-093

E-mail: enquiry@enviro world.in

Web: www.enviroworld.in

 PRESENCE:

 MUMBAI

 AHMEDABAD

 PUNE

 HYDERABAD

 VIZAG

 DELHI

 GOA

